

HANDWHEELS

The Straight Type Handle Wheels are cast, tumbled clean and finished without surface treatment. All Straight Type Hand wheels are 3 and 4 spoke design.

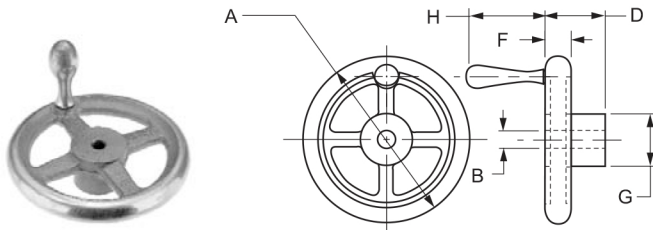

STRAIGHT TYPE HAND WHEELS						
No Handle - Cast Iron						
P/N	DIMENSIONS					
	A	B	D	F	G	H
*355-01	4	3/8	1-1/8	5/8	1-1/4	-
*355-02	5	3/8	1-1/8	5/8	1-1/2	-
*355-03	6	1/2	1-1/4	3/4	1-5/8	-
*355-04	8	5/8	1-3/8	7/8	1-7/8	-
*355-05	10	5/8	2-1/4	1	2-1/4	-
*355-06	12	3/4	3	1-1/4	3	-
*355-07	14	3/4	3-1/2	1-1/4	3	-

STRAIGHT TYPE HAND WHEELS						
Solid Handle - Cast Iron						
P/N	DIMENSIONS					
	A	B	D	F	G	H
*355-13	4	3/8	1-1/8	5/8	1-1/4	2
*355-14	5	3/8	1-1/8	5/8	1-1/2	2-1/8
*355-15	6	1/2	1-1/4	3/4	1-5/8	2-3/4
*355-16	8	5/8	1-3/8	7/8	1-7/8	3-7/32
*355-17	10	5/8	2-1/4	1	2-1/4	3-7/16
*355-18	12	3/4	3	1-1/4	3	4-1/16
*355-19	14	3/4	3-1/2	1-1/4	3	4-1/16

STRAIGHT TYPE HAND WHEELS						
Revolving Handle - Cast Iron						
P/N	DIMENSIONS					
	A	B	D	F	G	H
*355-25	4	3/8	1-1/8	5/8	1-1/4	2-1/16
*355-26	5	3/8	1-1/8	5/8	1-1/2	2-1/16
*355-27	6	1/2	1-1/4	3/4	1-5/8	3-1/32
*355-28	8	5/8	1-3/8	7/8	1-7/8	3-9/32
*355-29	10	5/8	2-1/4	1	2-1/4	3-9/32
*355-30	12	3/4	3	1-1/4	3	4-1/8
*355-31	14	3/4	3-1/2	1-1/4	3	4-1/8

Economical Hand Wheels come with round machined rim and two different platings to fit your budget. The hub center is drilled for easy modification and the wheel is tapped and ready for the handle (see part 355-50 - 355-59 and sold separately.) 8" sizes and larger comes with wavy inside rim for better gripping. This wheel has a slim cross section and is well proportioned. These come in three or five spoke models.

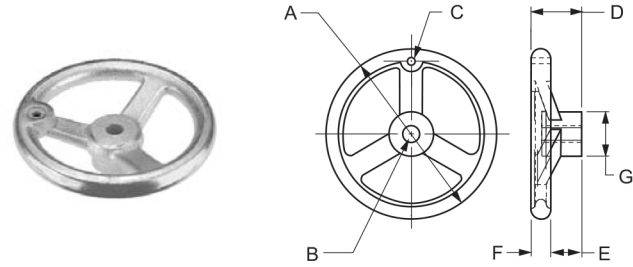

HAND WHEELS							
Cast Iron - Tumbled and Smoothed							
P/N	DIMENSIONS						
	A	B	C	D	E	F	G
355-40	4	3/8	10-24	1-1/2	15/16	9/16	1-1/8
355-42	5	3/8	1/4-20	1-5/8	1	5/8	1-1/4
355-44	6	1/2	5/16-18	1-13/16	1-1/8	11/16	1-3/8
355-46	8	5/8	3/8-16	2-3/16	1-5/16	7/8	1-5/8
355-48	10	5/8	3/8-16	2-3/8	15/16	15/16	1-7/8

HAND WHEELS							
Cast Iron - Chrome Plated							
P/N	DIMENSIONS						
	A	B	C	D	E	F	G
355-41	4	3/8	10-24	1-1/2	15/16	9/16	1-1/8
355-43	5	3/8	1/4-20	1-5/8	1	5/8	1-1/4
355-45	6	1/2	5/16-18	1-13/16	1-1/8	11/16	1-3/8
355-47	8	5/8	3/8-16	2-3/16	1-5/16	7/8	1-5/8
355-49	10	5/8	3/8-16	2-3/8	15/16	15/16	1-7/8

• - Discontinued, available while supplies last

HANDWHEELS

These fixed / revolving steel handles are well proportioned and have comfortable grips.

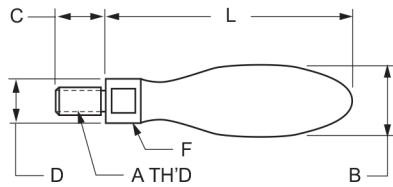

THREADED HANDLES Fixed Handle - Chrome Plated						
P/N	DIMENSIONS					
	A	B	C	D	E	F
355-50	10-24	1/2	3/8	.32	1-11/16	-
355-52	1/4-20	5/8	1/2	.40	2	-
355-54	5/16-18	13/16	9/16	.51	2-5/8	-
355-56	3/8-16	1	11/16	.63	3-3/16	-
355-58	1/2-13	1-1/4	13/16	.75	3-3/4	-

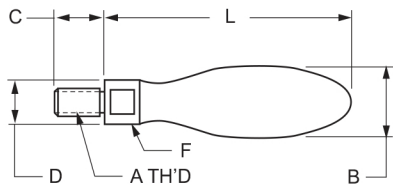

THREADED HANDLES Revolving Handle - Chrome Plated						
P/N	DIMENSIONS					
	A	B	C	D	E	F
355-51	10-24	1/2	3/8	.32	1-7/8	-
355-53	1/4-20	5/8	1/2	.40	2-1/4	-
355-54	5/16-18	13/16	9/16	.51	2-13/16	-
355-57	3/8-16	1	11/16	.63	3-3/8	-
355-59	1/2-13	1-1/4	13/16	.75	4	-

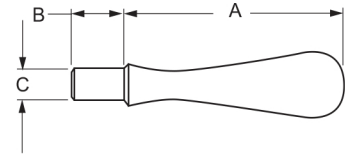

MACHINE HANDLES Press Fit - Revolving Handle - Chrome Plated			
P/N	DIMENSIONS		
	A	B	C
356-02	2-1/16	9/16	5/16
356-04	3-1/32	3/4	3/8
356-06	3-9/32	3/4	7/16
356-08	4-3/16	15/16	1/2

MACHINE HANDLES Press Fit - Revolving Handle - Chrome Plated			
P/N	DIMENSIONS		
	A	B	C
356-10	1-9/32	1/4	7/16
356-12	1-9/16	1/4	7/16
356-14	1-23/32	5/16	7/16
356-18	2-1/8	3/8	9/16
356-24	3-7/32	7/16	11/16
356-30	4-1/16	1/2	15/16

The Aluminum Handwheel is an economical, yet well-made hand wheel. It has a round machined rim. All un-machined surfaces are tumbled smooth.

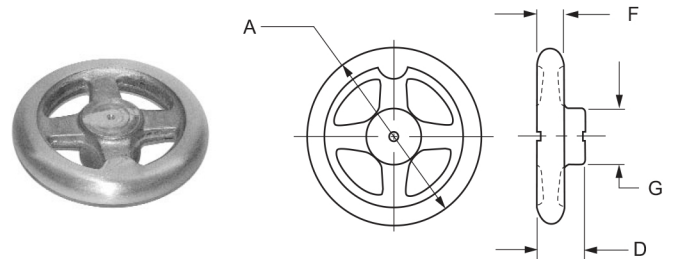

ALUMINUM HANDWHEEL				
P/N	DIMENSIONS			
	A	D	F	G
*356-40	4	1-1/8	5/8	1-1/4
*356-44	6	1-1/4	3/4	1-5/8
*356-46	8	1-3/8	7/8	1-7/8
*356-48	10	2-1/4	1	2-1/4

* Discontinued available while supplies last.

HANDWHEELS

The Stainless Steel Handwheel has both a wheel and revolving handle that are completely machined to a smooth finish. The dish type handwheel hub is center drilled to assist in drilling the hole size required.

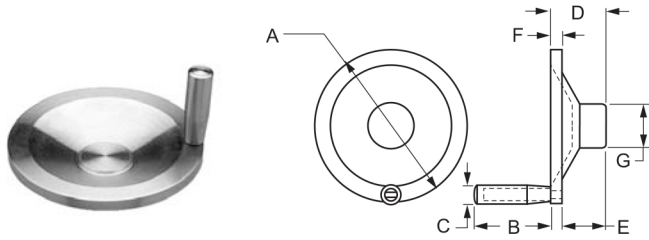

This high quality cast iron wheel is superbly finished in a polished and satin chrome plating that is rugged in design and construction. The wheel is engineered with three offset spokes and has a square outside rim to enhance appearance. Spokes are angular. Available as two types: one with a hole for a handle and one without. The handle must be ordered separately.

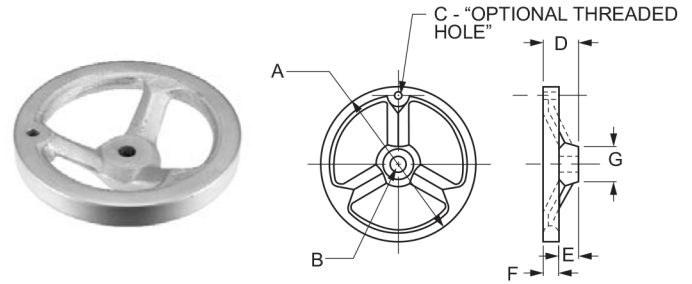

STAINLESS STEEL HANDWHEELS

300 Stainless Steel

P/N	DIMENSIONS						
	A	B	C	D	E	F	G
356-50	3	1.49	.39	1.10	.67	.24	.87
356-52	4	1.57	.47	1.25	.71	.31	1.02
356-54	6	2.50	.75	1.50	.87	.39	1.50
356-56	8	3.00	.87	1.80	.95	.50	1.80
356-58	10	3.00	.87	2.00	1.05	.62	2.00

HANDWHEELS

Threaded - Cast Iron - Bright Chrome Plated

P/N	DIMENSIONS						
	A	B	C	D	E	F	G
358-00	4	3/8	1/4-20	1-1/4	3/4	9/16	7/8
358-05	5	3/8	5/16-18	1-7/16	3/4	5/8	1-1/8
358-10	6-1/4	1/2	3/8-16	1-9/16	13/16	3/4	1-1/4
358-15	8	5/8	3/8-16	1-3/4	1	25/32	1-7/16
358-20	10	5/8	1/2-13	2	1-3/16	7/8	1-3/4
358-25	12-5/8	3/4	1/2-13	2-5/32	1-1/4	15/16	2-3/16

HANDWHEELS

No Hole - Cast Iron - Bright Chrome Plated

P/N	DIMENSIONS						
	A	B	C	D	E	F	G
358-50	4	3/8	-	1-1/4	3/4	9/16	7/8
358-55	5	3/8	-	1-7/16	3/4	5/8	1-1/8
358-60	6-1/4	1/2	-	1-9/16	13/16	3/4	1-1/4
358-65	8	5/8	-	1-3/4	1	25/32	1-7/16
358-70	10	5/8	-	2	1-3/16	7/8	1-3/4
358-75	12-5/8	3/4	-	2-5/32	1-1/4	15/16	2-3/16

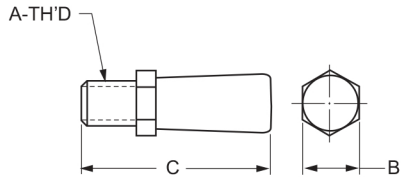

FINGER HANDLES

Black Oxide Finish

P/N	DIMENSIONS		
	A	B	C
357-25	10-24	1/4	11/16
357-30	10-32	1/4	11/16
357-35	5/16-18	3/8	1-1/4

HANDWHEELS

A high quality cast iron wheel in polished satin chrome. Specifications similar to 358 series, except that it come with a wavy rim for positive grip. These are ideal where heavy torque may be needed.

A low cost, yet exceptionally well made hand wheel. It comes with a round outside rim. The hub is center drilled with a 1/8" pilot hole in the hub center for easy modification. All un-modified surfaces are tumbled smooth.

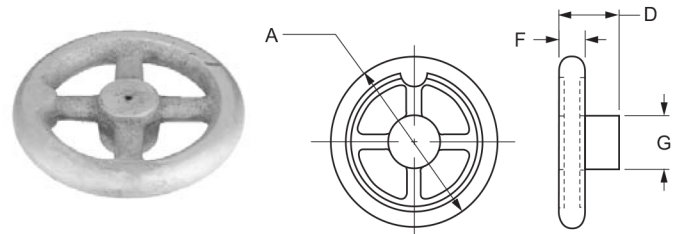
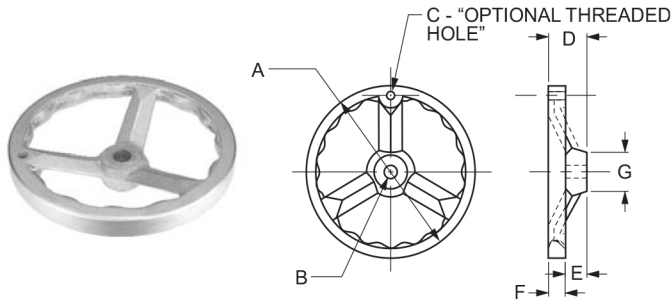

EASY GRIP HANDWHEELS							
Wavy Rim - Threaded - Cast Iron - Bright Chrome Plated							
P/N	DIMENSIONS						
	A	B	C	D	E	F	G
*359-10	8	5/8	3/8-16	1-3/4	1	25/32	1-7/16
*359-12	10	5/8	1/2-13	2	1-3/16	7/8	1-3/4
*359-14	12-5/8	3/4	1/2-13	2-5/32	1-1/4	15/16	2-3/16

ECONO HANDWHEELS				
Cast Iron - Chrome Plated				
P/N	DIMENSIONS			
	A	D	F	G
359-50	3	1-1/16	5/8	1
359-55	4	1-1/8	11/16	1-1/4
359-60	5	1-1/8	5/8	1-1/2
359-65	6	1-1/4	3/4	1-5/8
359-70	8	1-3/8	7/8	1-7/8
359-71	10	2-1/4	1	2-1/4

EASY GRIP HANDWHEELS							
Wavy Rim - No Hole - Cast Iron - Bright Chrome Plated							
P/N	DIMENSIONS						
	A	B	C	D	E	F	G
*359-20	8	5/8	-	1-3/4	1	25/32	1-7/16
*359-22	10	5/8	-	2	1-3/16	7/8	1-3/4
*359-24	12-5/8	3/4	-	2-5/32	1-1/4	15/16	2-3/16

NOTE: Part 359-65 has a Light Zinc plating with NO polish.

The Plastic Handwheel is a strong, solid web hand wheel that is made of Bakelite and contains a steel hub insert with a hole in the center. This piece comes with a plastic revolving handle which needs to be assembled.

* Discontinued available while supplies last.

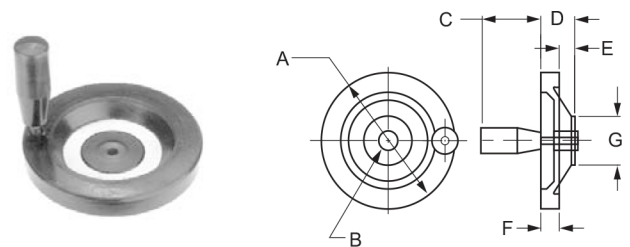

PLASTIC HANDWHEELS							
Bakelite - Folding Handle - Revolving Handle Included							
P/N	DIMENSIONS						
	A	B	C	D	E	F	G
*359-80	5-1/2	5/16	2-1/2	1-1/4	11/16	5/8	1-13/16
*359-85	6-5/8	3/8	3-1/8	1-1/2	13/16	11/16	2-1/16
*359-90	7-7/8	1/2	3-1/8	1-3/4	1	3/4	2-3/8

* Discontinued available while supplies last.

HANDWHEELS & HANDLES

A modern, lightweight wheel with two offset spokes. The durable, high impact black abs plastic handle revolves and is foldable.

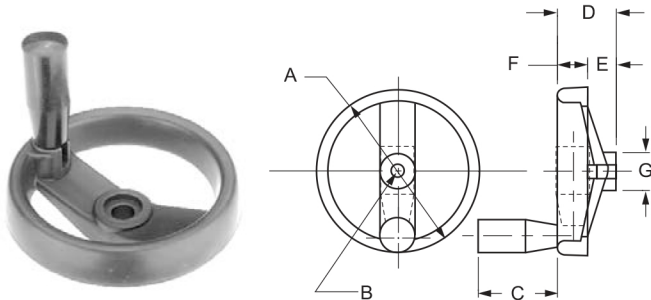

PLASTIC HANDWHEELS							
ABS Plastic - Folding Handle - Revolving Handle Included							
P/N	DIMENSIONS						
	A	B	C	D	E	F	G
*260-10	4-15/16	1/2	2	1-3/4	23/32	7/8	1-1/4
*260-20	6-5/16	5/8	2-1/2	1-7/8	25/32	1	1-9/16
*260-30	7-7/8	3/4	3-1/8	2-1/8	1	1-1/8	2

* Discontinued, available while supplies last.

Square style with aluminum trim ring. It is made of Strong Bakelite and has strong construction. This piece has a wave inner ring to make this easier to grip.

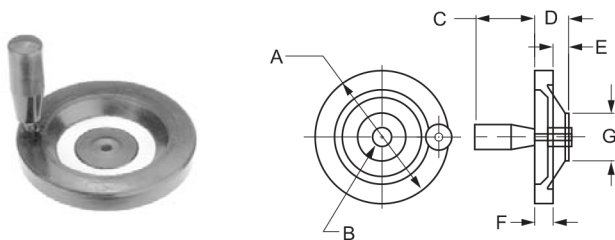

PLASTIC HANDWHEELS							
Bakelite - Folding Handle - Revolving Handle Included							
P/N	DIMENSIONS						
	A	B	C	D	E	F	G
*360-50	3-15/16	3/8	2	1-5/8	23/32	1	1-9/16
*360-55	4-15/16	1/2	2-1/2	1-13/16	23/32	1-3/16	1-3/4
*360-60	6-5/16	5/8	3-1/8	2-1/8	23/32	1-1/4	2-1/8

* Discontinued available while supplies last.

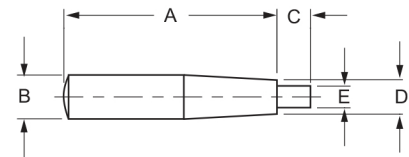

SOLID STEEL HANDLE					
Press Fit Type - Satin Chrome Plate					
P/N	DIMENSIONS				
	A	B	C	D	E
361-02	2	1/2	7/16	1/4	13/32
361-04	2-1/2	5/8	9/16	5/16	15/32
361-06	3-1/4	3/4	11/16	3/8	19/32
361-08	3-1/2	1	13/16	1/2	23/32

SOLID STEEL HANDLE					
Threaded Type - Satin Chrome Plate					
P/N	DIMENSIONS				
	A	B	C	D	E
361-12	2	1/2	7/16	1/4-20	13/32
361-14	2-1/2	5/8	9/16	5/16-18	15/32
361-16	3-1/4	3/4	11/16	3/8-16	19/32
361-18	3-1/2	1	13/16	1/2-13	23/32

These handles are similar to the Solid Steel Handle except that this piece revolves. The handle comes in two parts. The core shaft must be press fitted or threaded in to the handwheel before the outer shell is inserted onto the core.

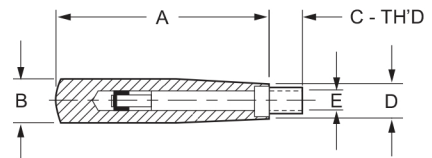

REVOLVING STEEL HANDLE					
Press Fit Type - Satin Chrome Plate					
P/N	DIMENSIONS				
	A	B	C	D	E
361-22	2	5/8	1/2	1/4	15/32
361-24	2-1/2	3/4	9/16	5/16	9/16
361-26	3-1/4	7/8	5/8	3/8	5/8
361-28	4	1	3/4	1/2	23/32